

www.planwell.co.uk

**Planwell**  
*roofing*  
Supplies

ELIMINATES  
CONDENSATION  
PROBLEMS \*

# INSULATED ROOFING

INSULATION FOR . . .

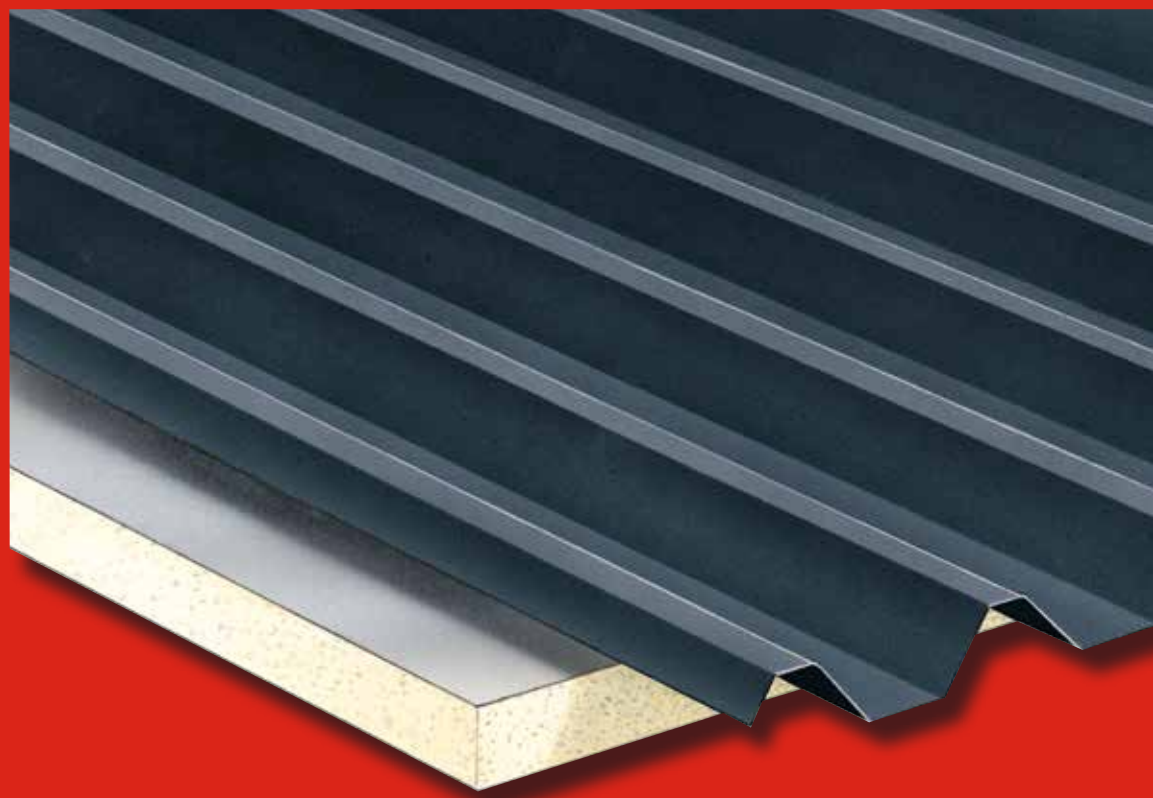

***THE BEST CHOICE  
- FOR YOUR NEW ROOF***

**FREEPHONE  
PLANWELL ON**

**0800 02 88 272**

# PLANWELL INSULATED

## - A WARM ROOF FOR LIFE -

Planwell's Permaroof System can incorporate insulation for any new or re-roofing works.

Installation is quick and simple and involves fitting Planwell's rigid Insulation Boarding then fitting the Permaroof sheeting on top. This creates a "warm roof" system.

Having an insulated roof fitted has numerous advantages (see opposite page). The main advantages are:-

- Avoids condensation problems\*
- Creates a warm, dry and usable room/garage
- Keeps the heat in a property (saves fuel bills / saves money)
- Reduces noise
- Adds value to your property
- 10 or 20 year written guarantee available
- Lasts a lifetime

An insulated "warm roof" system would normally be installed on the following:-

- Garages/workshops
- Houses
- Kitchens/bathrooms
- Bedrooms
- Offices
- Any roof where avoiding condensation is essential



It is important that you purchase the correct materials for your roofing project and that you receive proper advice.

With over 30 years experience in the roofing industry, Planwell's Co-Directors, Mark and Murray Duncan, offer free proper professional advice on all roofing projects from a standard shed roof to a new domestic or industrial building.

We have a freephone, free advice helpline (Monday to Friday) and can usually provide you with an instant quotation for your roofing requirements within minutes.

Planwell also have their own transport vehicles and provide a delivery service throughout Scotland.

**AN INSULATED ROOF - THE BEST CHOICE FOR YOUR NEW ROOF**

### TYPICAL DESIGN DETAILS Over Purlin Lining

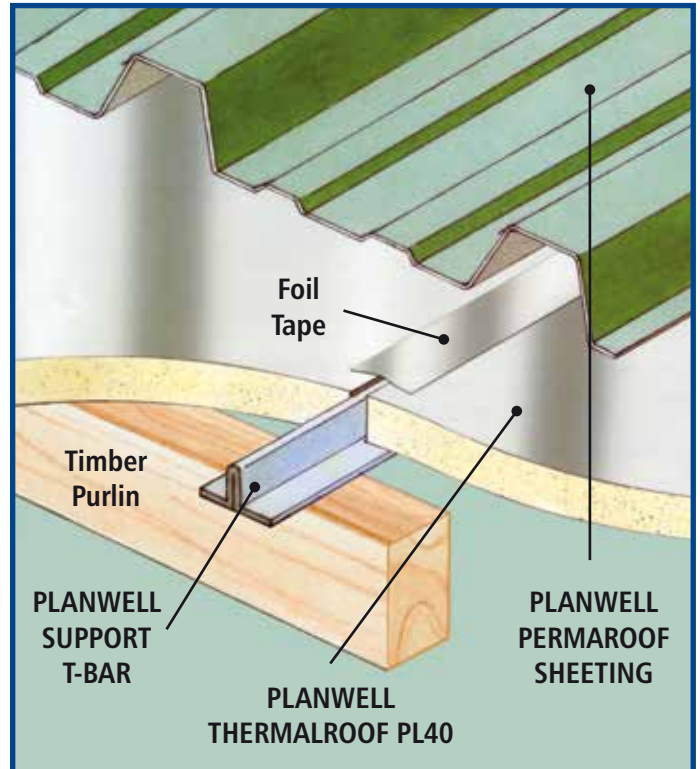

### INSULATION DETAILS

**Board Thickness** - 40mm available from stock  
(thicker boards are available if required)

**Board Sizes** - 1.2m x 2.4m

**Appearance** - Silver foil on both sides

**Similar Products** - Kingspan Thermaliner TL60

## PLANWELL'S INSULATED ROOFING - IDEAL FOR...



\* WHEN INSTALLED AS PER MANUFACTURER'S WRITTEN INSTRUCTIONS



**BEFORE - LEAKING**



**DURING - NEW ROOF BEING FITTED WITH INSULATION**



**AFTER - SEALED, WARM & DRY**

**THE BEST CHOICE FOR YOUR NEW ROOF**

# INSULATED ROOFING

## "TICKS ALL THE BOXES"

- ✓ **Eliminates condensation problems\***
- ✓ **Creates a warm, dry and usable room / building**
- ✓ **Keeps the heat in your property**
- ✓ **Best quality at best prices**
- ✓ **Saves fuel bills saves £££s**
- ✓ **Reduces noise**
- ✓ **Adds value to your property**
- ✓ **10 or 20 year written guarantee available**
- ✓ **Attractive internal appearance**
- ✓ **Saves energy, good for the environment**
- ✓ **Ideal for new and re-roofing works**
- ✓ **Quick and simple installation**
- ✓ **The thickness of insulation board can be increased if required**
- ✓ **Permaroof sheeting is available in a wide choice of colours, and in either Polyester or Plastisol finishes**
- ✓ **No "minimum order" charges**
- ✓ **Planwell - unbeatable quality at unbeatable prices, buy direct from the manufacturer**

Delivered throughout Scotland

**AVAILABLE IN A WIDE CHOICE OF COLOURS**



GOOSEWING GREY    MERLIN GREY    SLATE BLUE    TERRACOTTA RED    VANDYKE BROWN    OLIVE GREEN    JUNIPER GREEN    BLACK

The colours listed above are as a guidance only, due to pigment variations in the printing process the colours may not be exact. For the exact colour please contact Planwell for colour sheet samples. Please note certain colours are only available in Plastisol finish, check with Planwell for further details.



## INSULATED ROOFING - LOOK AT THE DIFFERENCE



# FREE

- PERMAROOF FIXING GUIDE
- FIXING SOCKET
- SAFETY GLOVES

**ALL FREE with each order placed**



# INSULATED ROOFING A QUICK & SIMPLE INSTALLATION

## BEFORE STARTING

- The recommended minimum fall/slope for all metal sheet roofs is 5°.
- Before the start of roofing works please take five minutes to read the *Planwell Fixing Guide*, this is supplied along with all orders placed.
- Purlins should be fitted 1m to 1.2m (4ft) apart. if your purlins are wider apart than this then a 0.7mm thick sheet would be required.

## INSTALLING AN INSULATED ROOF

- Firstly place an insulation board on top of timber purlins. Fix the insulation board with one or two nails into the purlins (to keep in place). The standard insulation board dimensions are 2.4m long x 1.2m wide (40mm thick).
- If, for example, the roof sheet length is 3.6m long then this would require one full insulation board 2.4mm long then half an insulation board 1.2mm long.
- Insulation boards can be cut with a saw or sharp stanley knife.
- Simply butt the two insulation boards together and tape the 'joint' on the boards with silver joint tape (provided). This will help to achieve a continuous 'vapour barrier'. **IMPORTANT this must be done on all joints of insulation boards.**
- It is then simply a case of placing the first roofing sheet on top of the insulation board, marking with a pencil where the purlins are and then fixing through this with the self drilling screws provided (usually 80mm long).
- Once you have fixed your first sheet you will see that the insulation is 200mm (8") ahead of the roofing sheet. A T/Bar should then be slid below the insulation board (this helps support the edge of the insulation board and will hide the 'joint' of the insulation boards from inside the building) giving a neat appearance.
- It is then simply a case of butting your next insulation board against the previous, taping the joint on top, then continue by securing your next roofing sheet as previous.

## "SMALL TIPS"

- If, for example, you are fitting two insulation boards on a 3.6m roofing sheet you would need one full board at 2.4mm long and a half board at 1.2m long.
- It always looks better from the inside of the building when the joint of the 2.4m long board and the half board are fitted directly on top of a timber purlin as this in effect 'hides' the joint. This is easily achieved by ensuring that the two boards land 'halfway' across a timber purlin on the area concerned.  
**NOTE** if this is not possible then 'cross' T/Bars can also be introduced (T/Bars going across the board rather than up and down).
- If you have a timber fascia, keep the insulation board back level or behind this fascia and let the top roofing sheet project out the 2' or 3' into the gutter.  
The insulation board does not need to come out all the way to the end of the roofing sheet.  
Keeping the insulation back level or behind the fascia will stop birds (etc) from 'pecking' at the insulation boards.

## INSTALLING 'DOUBLE SKINNED' ROOFLIGHTS

This usually involves fitting two different profiles of rooflights with a packer in between - see the *Planwell Fixing Guide* for more details on this.

## TECHNICAL HELP

Installation of Planwell's insulated roofing is as you can see very quick and simple.

If however you require any more details/information then please contact the Planwell helpline (Monday to Friday) on the freephone number on this brochure.

All photographs, technical information, logos and sketches contained within this brochure remain the property of Planwell Roofing Supplies Ltd and cannot be copied or reproduced without obtaining written permission from Planwell Roofing Supplies Ltd.



**PLANWELL'S INSULATING  
AND ROOFING SHEETS -  
EASY TO HANDLE & INSTALL**



*Profile Roofing Manufacturers*



PLANWELL ROOFING SUPPLIES LTD. "THE ROOFING CENTRE" MARCH ROAD INDUSTRIAL ESTATE BUCKIE AB56 4BU

**TEL 01542 832170 FAX 01542 832182**

A John Duncan  
Family Company

email: [enquiries@planwell.co.uk](mailto:enquiries@planwell.co.uk) [www.planwell.co.uk](http://www.planwell.co.uk)